

MIGOMAG 195 MACHINE BREAKDOWN AND PARTS DESCRIPTION

MIGOMAG 195 P 2.0 220/240V

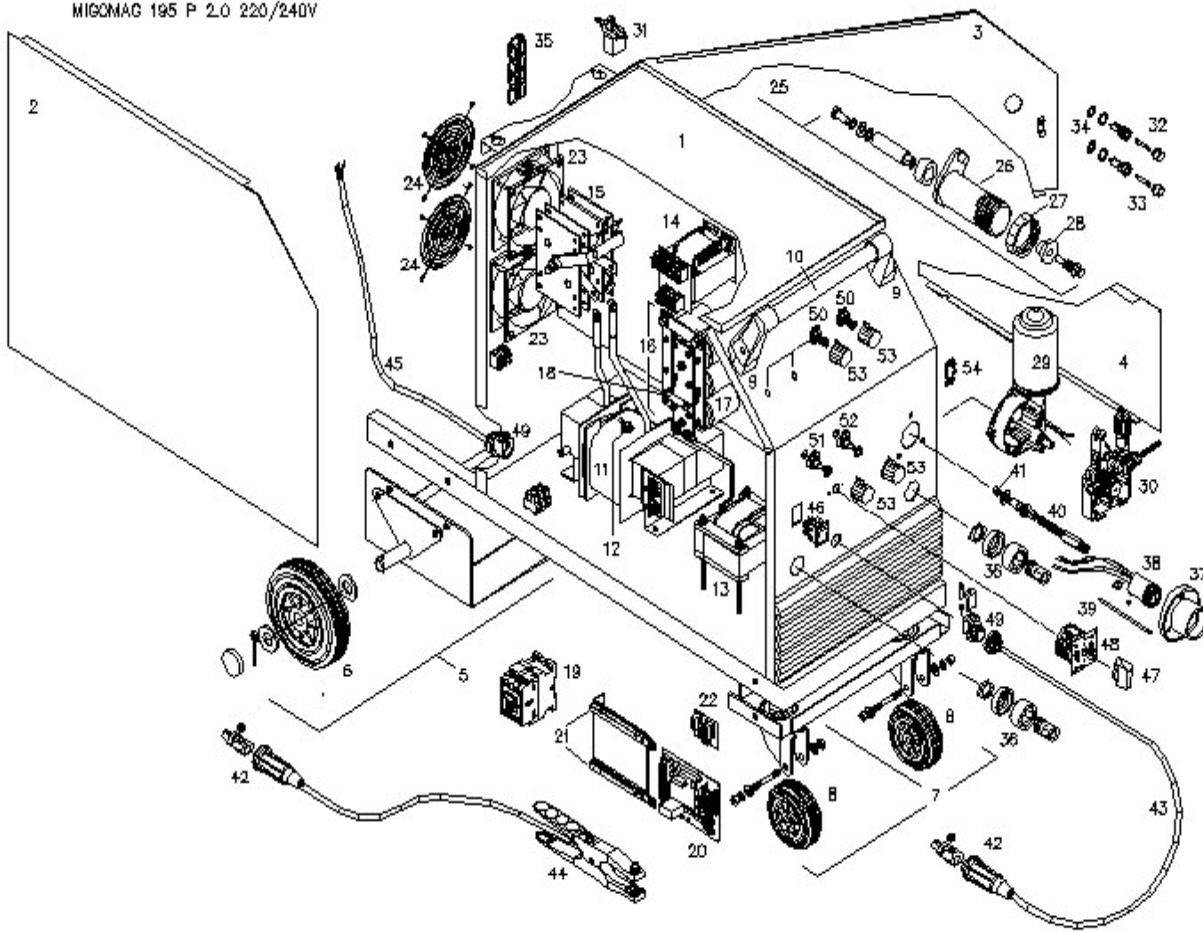

| FIG | PART NO. | DESCRIPTION | FIG | PART NO. | DESCRIPTION |
|-----|----------|-----------------------------------|-------|-----------|-------------------------------|
| 2 | 86001071 | Side Panel Left Hand | 27 | 86003010 | Hub Nut |
| 3 | 86001070 | Opening Side Panel | 28 | 86006050 | Friction Brake Washer |
| 4 | 86001069 | Side Panel Right Hand Small | 29 | 86003003 | Drive Motor |
| 5 | 86001041 | Rear Wheel Assy Complete | 30 | | Wire Feed Unit Complete |
| 6 | 86001038 | Rear Wheel All models dia.160mm | | 86003004A | Drive Bracket Assembly |
| 7 | 86001048 | Front Wheel Assy Complete | 31 | 86006001 | Gas Solenoid Valve 230V |
| 8 | 86001051 | Front Wheel All models dia.100mm | 32 | 86002052P | Fuse 1AMP 20 X 5 (10pkt) |
| 9 | 86001082 | Handle Support bracket | 33 | 86002056P | Fuse 3.15AMP 30 X 6 (10pkt) |
| 10 | 86001083 | Handle Pipe | 34 | 86002070 | Fuse Holder G30 |
| 11 | 86004031 | Transformer Main M195 | 36 | P5110014 | Dinse Socket 35 |
| 12 | 86001031 | Thermoswitch 110C for M/Transform | 37 | 5010616 | Housing for Central Adaptor |
| 13 | 86004006 | Choke | 37-41 | 86003001 | Central Adaptor Complete |
| 14 | 86004009 | Transformer Auxillary | 39 | 86003041 | Guide Tube 1.0-1.2 |
| 15 | 86005006 | Rectifier Unit | 42 | P5110015 | Dinse Plug 35 |
| 16 | 86001023 | Capacitor Unit Complete | 43 | FW16 | Rubber Cable 16m ² |
| 17 | 86001020 | Capacitor | 44 | MEC200 | Earth Clamp 200 |
| 18 | 86001032 | Bleed off Resistor | 46 | 86001005 | Switch ON/OFF |
| 19 | 86001017 | Main Contactor | 47 | 86001046 | Knob for Voltage Switch |
| 20 | 86002010 | PCB | 48 | 86001002 | Switch 6 Position |
| 21 | 86002007 | PCB Holder | 50 | 86001043 | Pot Spot / Pulse 470KA |
| 23 | 86001030 | Fan | 51 | 86001044 | Pot wire feed 10KA |
| 24 | 86001029 | Fan Guard | 52 | 86001047 | Burnback Pot 4K7A |
| 25 | 86003011 | Hub Complete | 53 | 86001045 | Complete Knob for Potmeter |
| 26 | 86003012 | Hub Only | | 86001037 | Swivel Castor Complete |