

CLASSIC 315PS MACHINE BREAKDOWN AND PARTS DESCRIPTION

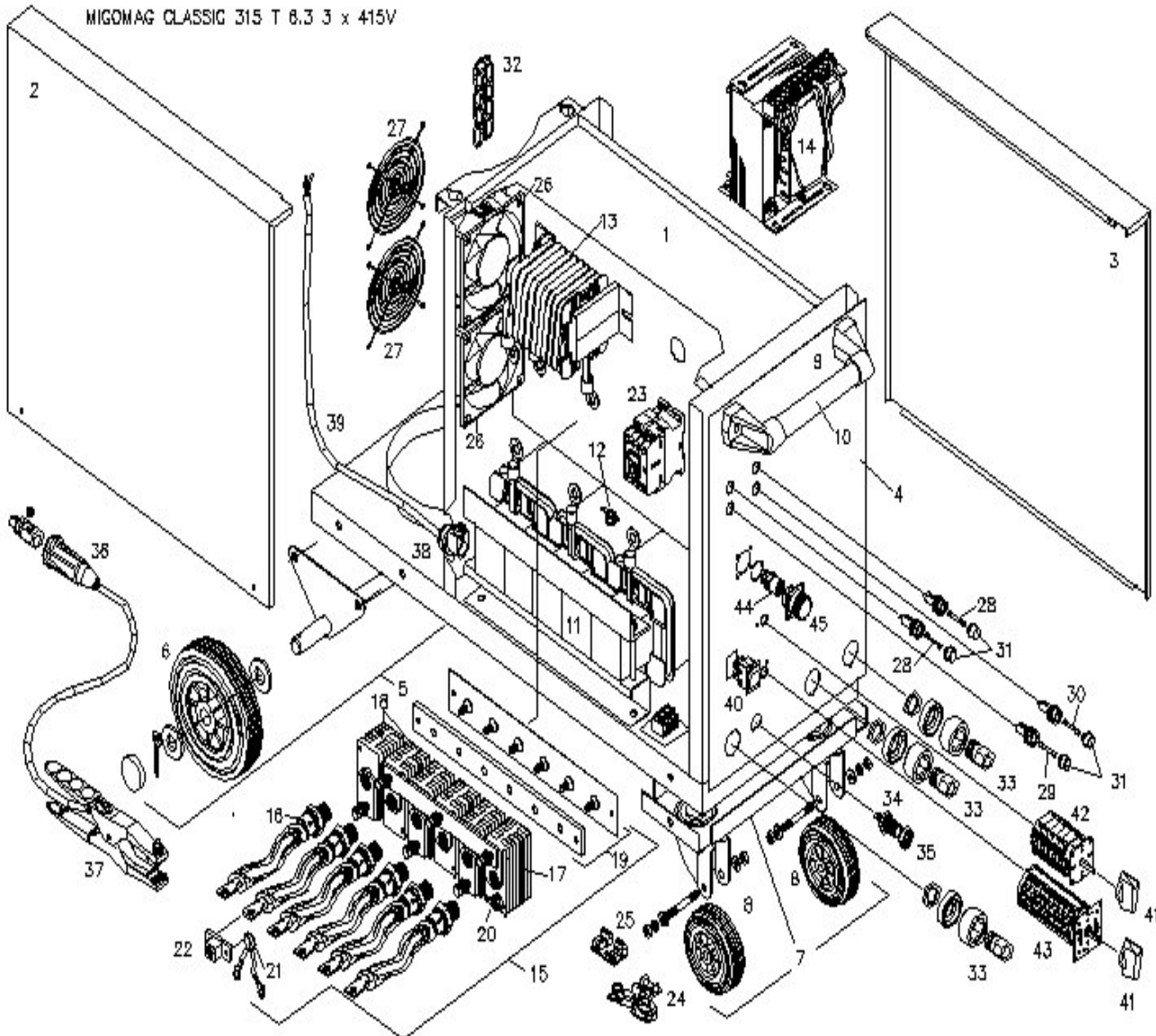

FIG	PART NO.	DESCRIPTION	FIG	PART NO.	DESCRIPTION
2	86001079B	Left Hand Side Panel	23	86001019	Main Contactor DIL-K7-10
3	86001079A	Right Hand Side Panel	26	86001030	Fan PAPST
5	86001042B	Rear Wheel Assy	27	86001029	Fan Guard
6	86001038	Rubber Wheel dia. 160mm	28	86002054P	Fuse 2.5AMP 30 x 6 (10pkt)
7	86001050A	Front Wheel Assy	29	86002052P	Fuse 1AMP 20 x 5 (10pkt)
8	86001051	Rubber Wheel dia. 100mm	30	86002062P	Fuse 6.3AMP 30 x 6 (10pkt)
9	86001082	Handle Support bracket	31	86002070	Fuse Holder
10	86001085	Handle Pipe	33	P5110014	Dinse Socket 35
11	86004043	Transformer Main	34	86001097	Gas Socket
12	86001031	Thermoswitch 110C	35	86001097	Nut 3/8"
13	86004004	Choke	36	P5110015	Dinse Plug 35
14	86004015	Transformer Auxiliary	37	MEC500	Earth Clamp
16	86005001	Diode IR	40	86001005	Switch ON/OFF
16	86005000	Diode 2003	41	86001046	Knob for Voltage Selector Sw.
17	86005012	Heatsink M20x1.5	42	86001011	Switch 3 position
18	86005012A	Heatsink M20x1.5 + M4	43	86001004	Switch 8 position
19	86005013A	Heatsink Holder	44	86003080	Amphenol Adaptor Head (10p)
20	86001031A	Thermoswitch 80C	45	86003081	Body for Amph.Adaptor