

MIGOMAG 260 MACHINE BREAKDOWN AND PARTS DESCRIPTION

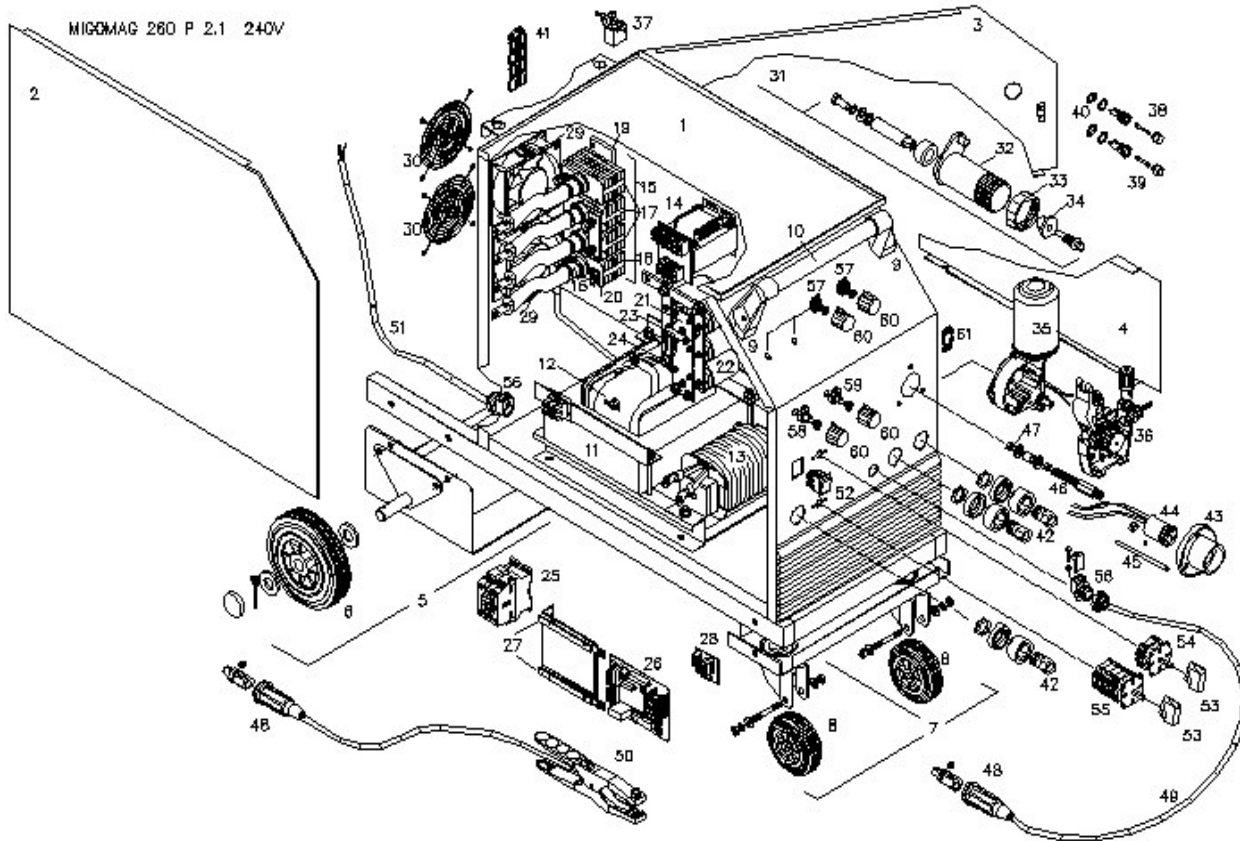

FIG	PART NO.	DESCRIPTION	FIG	PART NO.	DESCRIPTION
2	86001071	Left Hand Side Panel	31	86003011	Hub Complete
3	86001070	Opening Side Panel	32	86003012	Hub Only
4	86001069	Right Hand Side Panel Lower	33	86003010	Hub Nut
5	86001041	Rear Wheel Assy	34	86006050	Friction Brake Washer
6	86001038	Rubber Wheel dia. 160mm	35	86003003	Drive Motor
7	86001048	Front Wheel Assy	36		Wire Feed Unit
8	86001051	Rubber Wheel dia. 100mm		86003004	Drive Bracket Assy
9	86001082	Handle Support bracket	37	86006001	Gas Solenoid Valve 230V
10	86001083	Handle Pipe	38	86002052P	Fuse 1AMP 20 x 5 (10pkt)
11	86004033	Transformer Main	39	86002050P	Fuse 1AMP 30 x 6 (10pkt)
12	86001031	Thermoswitch 110C for M/Transf	40	86002070	Fuse Holder 30 x 6
13	86004005	Choke	42	P5110014	Dinse Socket 35
14	86004014	Transformer Auxillary	43	5010616	Housing for Central Adaptor
16	86005001	Diode IR	43-47	86003001	Central Adaptor Head
16	86005000	Diode 2003	45	86003041	Guide Tube 1.0 x 1.2
17	86005012	Heatsink M20x1.5	48	P5110015	Dinse Plug 35
18	86005012A	Heatsink M20x1.5 + M4	49	FW35	Rubber Cable 35mm ²
19	86005013	Heatsink Holder	50	MEC500	Earth Clamp
20	86001031A	Thermoswitch 80C	52	86001005	Switch ON/OFF
21	86001024	Capacitor Unit Complete	53	86001046	Knob for Voltage Switch
22	86001020	Capacitor	54	86001013	Switch 2 position
23	86001032	Bleed off Resistor	55	86001014	Switch 8 position
25	86001016	Main Contactor	57	86001043	Spot Pot 470KA
26	86002010	PCB	58	86001044	Wire Feed Pot 10KA
27	86002007	PCB Holder	59	86001047	Burnback Pot 4K7A
29	86001030	Fan	60	86001045	Complete Knob for Potmeter
30	86001029	Fan Guard			