

## MIGOMAG 350PS MACHINE BREAKDOWN AND PARTS DESCRIPTION

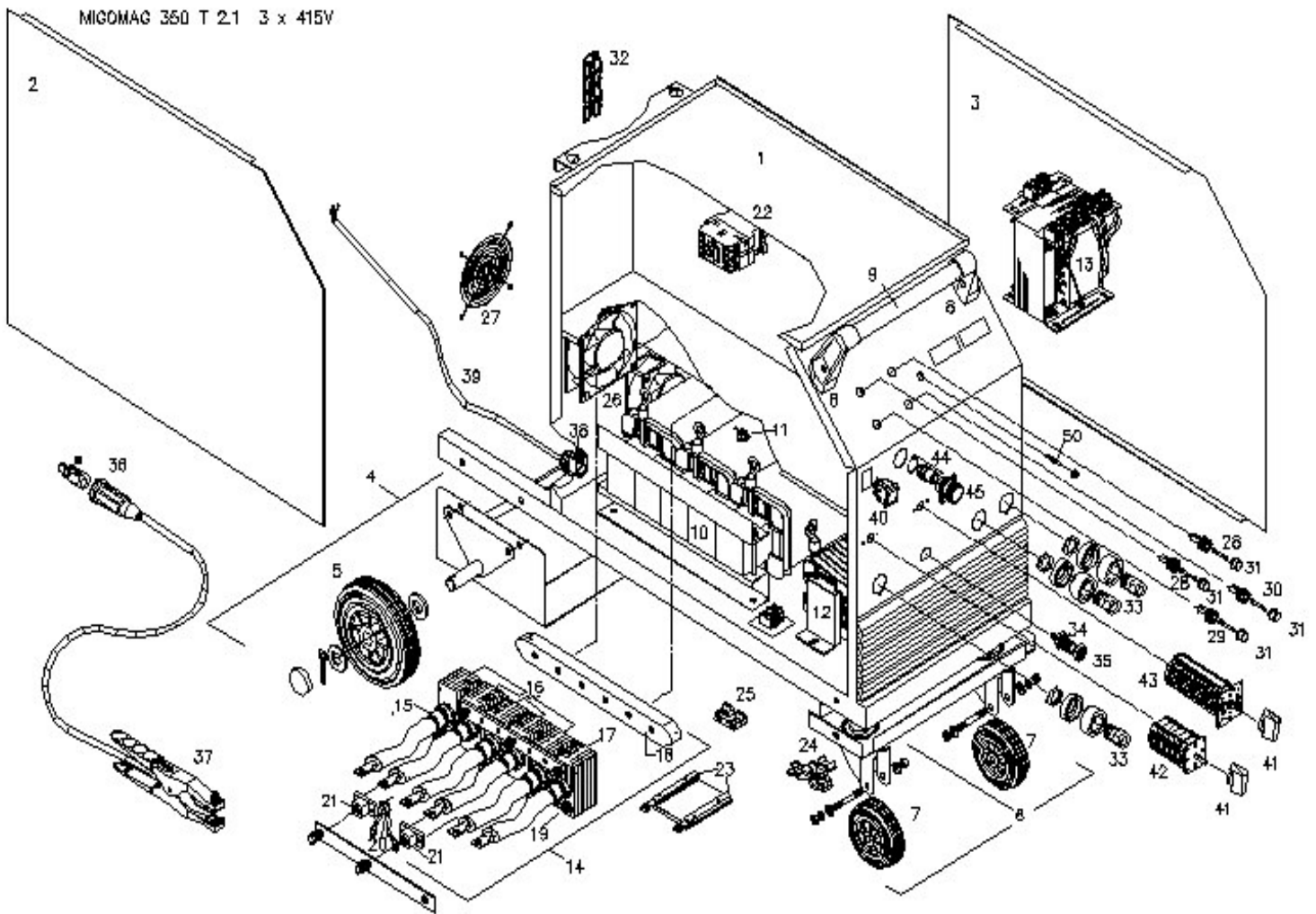

FIG	PART NO.	DESCRIPTION	FIG	PART NO.	DESCRIPTION
2	86001059A	Left Side Panel	23	86002007	PCB Holder
3	86001060A	Right Side Panel	26	86001027	Fan
4	86001042	Rear Castor Assy	27	86001029	Fan Guard
5	86001038	Rubber Wheel dia. 160mm	28	86002056P	Fuse 3.15AMP 30 x 6 (10pkt)
6	86001049	Front Wheel Assy	29	86002052P	Fuse 1AMP 20 x 5 (10pkt)
7	86001051	Rubber Wheel dia. 100mm	30	86002062P	Fuse 6.3AMP 30 x 6 (10pkt)
8	86001082	Handle Support Bracket	31	86002070	Fuse Holder
9	86001084	Handle Pipe	33	P5110014	Dinse Socket 35
10	86004044	Transformer Main	34	86001097	Gas Socket
11	86001031	Thermoswitch 110C for M/Transf	35	86001098	Nut 3/8"
12	86004008	Choke	36	P511015	Dinse Plug 35
13	86004015A	Transformer Auxilary	37	MEC500	Earth Clamp
15	86005001	Diode	40	86001005	Switch ON/OFF
15	86005000	Diode 2003	41	86001046	Knob for Voltage Switch
16	86005012	Heatsink M20x1.5	42	86001011	Switch 3 position
17	86005012A	Heatsink M20x1.5 + M4	43	86001004	Switch 8 position
18	86005013A	Heatsink Holder	44	86003080	Amphenol Adaptor head (10p)
19	86001031A	Thermoswitch 80C	45	86003081	Body for Amph.Adaptor
22	86001019	Main Contactor			