

SUPAMIG 200C MACHINE BREAKDOWN AND PARTS DESCRIPTIONS

SUPAMIG 200 C 5.1 240V

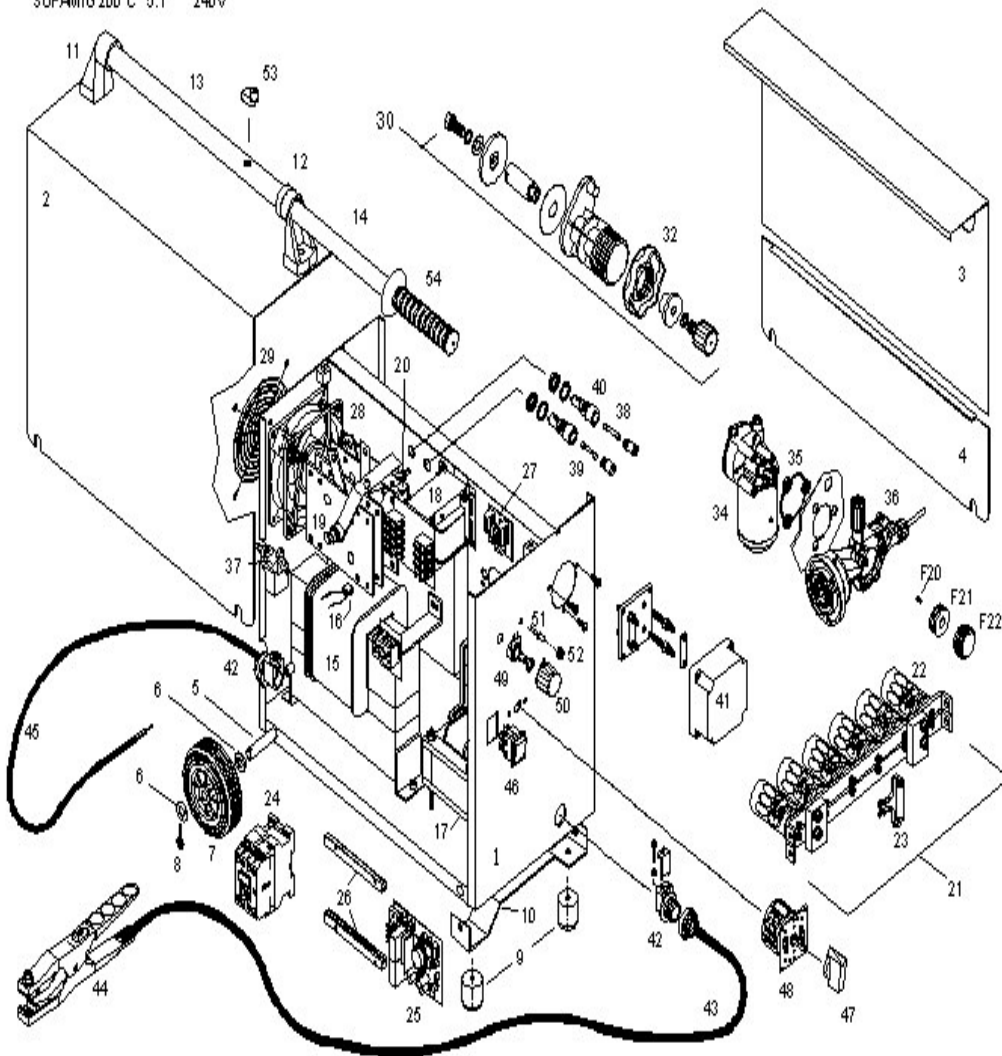

FIG	PART NO.	DESCRIPTION	FIG	PART NO.	DESCRIPTION
2	86001063	Left hand Side Panel 200C	29	86001029	Fan Guard
3	86001064	Opening Side Panel 200C	30	86002997	Hub Reel mini
4	86001065	Right Side Lower Panel 200C	34	86002995	Drive Motor 200C
7	86001051	Rubber Wheel Dia 100mm	35	86002993	Insulating Part for Drive Motor
9	86001053	Rubber Foot	36		Wire Feed Unit Complete
11	86001082	Handle support bracket		86002999	Drive Adaptor Assy
12	86001082A	Handle bracket Chrome	37	86006001	Gas Solenoid Valve
13	86001081	Handle Pipe Outer	38	86002051P	Fuse 1AMP 30 X 6 (10pkt)
14	86001081A	Handle Pipe	39	86002057P	Fuse 3.5AMP 20 X 5 (10PKT)
15	86004020	Main Transformer	40	86002070	Fuse Holder 30 X 6
16	86001031B	Thermoswitch 110oC	44	MEC200	Earth Clamp 250AMP
17	86004000	Choke	46	86001005	Switch ON/OFF
18	86004009	Auxiliary Transformer	47	86001046	Knob for Voltage Switch
19	86005005	Rectifier Unit	48	86001002	Switch 6 Position
21	86001022	Capacitor unit complete	49	86001044A	Pot Wire Feed 10KB
22	86001020	Capacitor	50	86001045	Complete Knob for Potentiometer
23	86001032	Bleed off Resistor	51	86002066	Fault Lamp RED
24	86001017	Main Contactor	53	86001081B	Securing Pin with spring
25	86002009	PCB	54	86001082B	Plastic Handle
26	86002007	PCB Holder	F20	86003018	Drive Roll Sec Knob 30mm
27	86002011	PCB Filter	F22	86003019A	Woodruff Key Oval Shape
28	86001027	Fan			